

PORTABLE FLOOR PLAN
SCALE 1/8" = 1'-0"

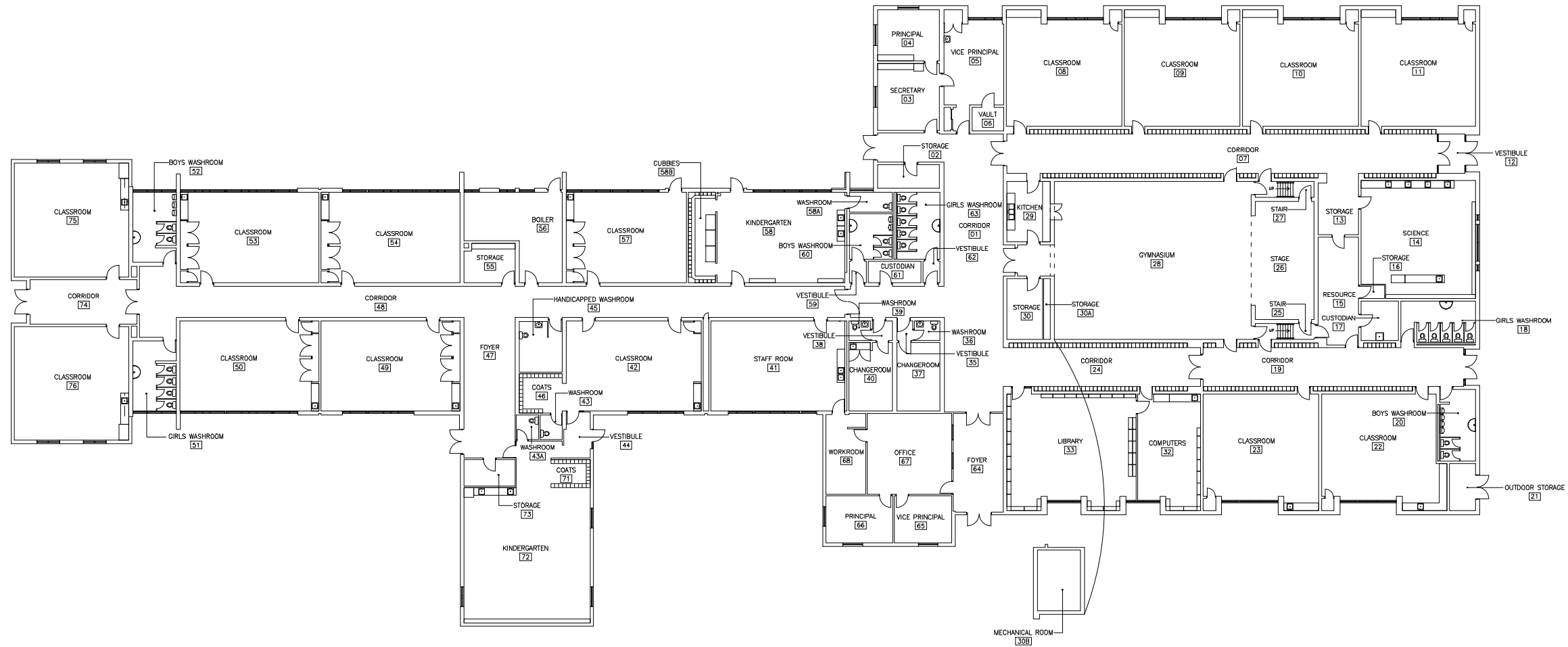

FIRST FLOOR PLAN
SCALE 1/8" = 1'-0"

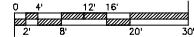

ARCHITECTURAL RENOVATIONS & ADDITIONS INCLUDED		
YEAR	ARCHITECT	PROJECT DESCRIPTION
2001	THE VENTIN GROUP LTD. ARCHITECTS	MULTIPLE ADDITIONS & RENOVATIONS
2007	THE VENTIN GROUP LTD. ARCHITECTS	2 CLASSROOM ADDITION & RENOVATIONS

DATABASE FW HISTORICAL RECORDS - ROOM NUMBER ADDITIONS AND DELETIONS	
DATE	ROOM # DESCRIPTION
MAY 02	34 VESTIBULE DOES NOT EXIST
JAN 01	-- (2000 ADDITION) - MAJOR RENOVATIONS OFFICE AREA
JAN 01	43 UNASSIGNED NOW PART OF KINDERGARTEN 42
APR 03	69 NOT USED
APR 03	70 NOT USED
APR 03	34 NOT USED
JAN 08	74 NEW CORRIDOR ADDED PART OF NEW CLASSROOM ADDITION
JAN 08	75 NEW CLASSROOM ADDED PART OF NEW ADDITION
JAN 08	76 NEW CLASSROOM ADDED PART OF NEW ADDITION
DEC 10	31 RENOVATED ROOM 31 COMPUTER LAB
FEB 14	58 MAJOR RENOVATION FOR KINDERGARTEN CLASSROOM
FEB 14	58A NEW WASHROOM ADDED
FEB 14	58B NEW ANAC FOR CUBBIES ADDED

**GRAND ERIE DISTRICT
SCHOOL BOARD**



REV	DATE	DESCRIPTION	BY	DWG

WALSH
PUBLIC SCHOOL

TITLE
FIRST FLOOR PLANS
ARCHITECTURAL

SCALE: 1/8" = 1'-0" DRAWN: DWG CHECKED: J. DOUGLAS APPR'D: J. DOUGLAS
DATE: SEPTEMBER 99 DATE: SEPT 99 DATE: SEPT 99

CONTRACT NO. 010 DWG NO. A-F1 REV 00